

# Coupling

External G-Thread (ISO 228/1)

## Working Pressure

1/4"	350 bar (5076 PSI)
3/8"	350 bar (5076 PSI)
1/2"	350 bar (5076 PSI)
3/4"	350 bar (5076 PSI)
1"	250 bar (3625 PSI)

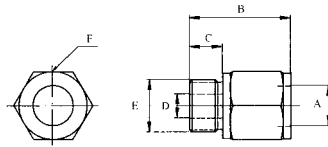

	Part No.	Connection (E)	A	B	C	D	F (hexagon)	
COUPLING – G-Thread	Series 810, 1/4"	14 810 0404	G 1/4"	10.0	38.4	12.0	4.5	20
	Series 810, 3/8"	14 810 0606	G 3/8"	13.0	41.9	12.0	7.0	24
	Series 810, 1/2"	14 810 0808	G 1/2"	16.0	43.5	14.0	9.5	28
	Series 810, 3/4"	14 810 1212	G 3/4"	23.0	56.0	16.0	15.0	36
	Series 810, 1"	14 810 1616	G 1"	30.0	67.0	18.0	21.0	41

# Coupling

Stop

## Working Pressure

1/4"	350 bar (5076 PSI)
3/8"	350 bar (5076 PSI)
1/2"	350 bar (5076 PSI)
3/4"	350 bar (5076 PSI)
1"	250 bar (3625 PSI)

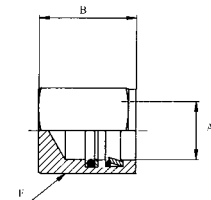

	Part No.	A	B	F (hexagon)	
COUPLING – Stop	Series 811, 1/4"	14 811 0400	10.0	29.4	20
	Series 811, 3/8"	14 811 0600	13.0	31.3	24
	Series 811, 1/2"	14 811 0800	16.0	32.3	28
	Series 811, 3/4"	14 811 1200	23.0	44.0	32
	Series 811, 1"	14 811 1600	30.0	55.0	41